

## 2005-08 ACCESSORIES AND EQUIPMENT

### Moonroof (Body Electrical) - RL

## COMPONENT LOCATION INDEX

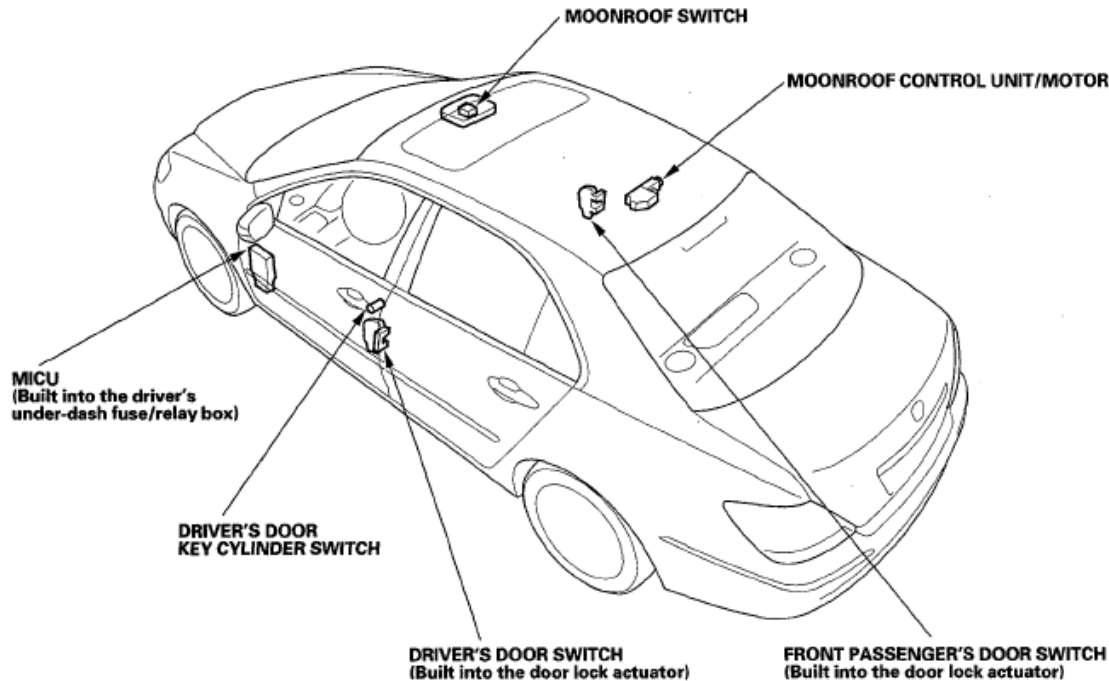

**Fig. 1: Identifying Moonroof Component Location**  
Courtesy of AMERICAN HONDA MOTOR CO., INC.

## RESETTING THE MOONROOF CONTROL UNIT

Resetting the moonroof is required when any of the following have occurred.

- The moonroof was moved manually with the battery dead or disconnected.
- The moonroof motor was replaced with a new one.
- Any of components related to the moonroof were replaced.
  - Wind deflector
  - Moonroof glass
  - Moonroof seal
  - Moonroof glass bracket
  - Moonroof cables, etc.

To reset the moonroof control unit, do these steps.

1. Close all doors and trunk.
2. Turn the ignition switch OFF.
3. Press and hold the tilt switch, and turn the ignition switch ON (II).

4. Release the tilt switch, and turn the ignition switch OFF.
5. Repeat steps 2 and 3 four times.
6. Press and hold the moonroof open switch until 3 seconds after the moonroof is fully opened.
7. Press and hold the moonroof close switch until 3 seconds after the moonroof is fully closed (tilted).
8. Confirm that the moonroof control unit is reset by using the moonroof AUTO OPEN and AUTO CLOSE function.

## CIRCUIT DIAGRAM

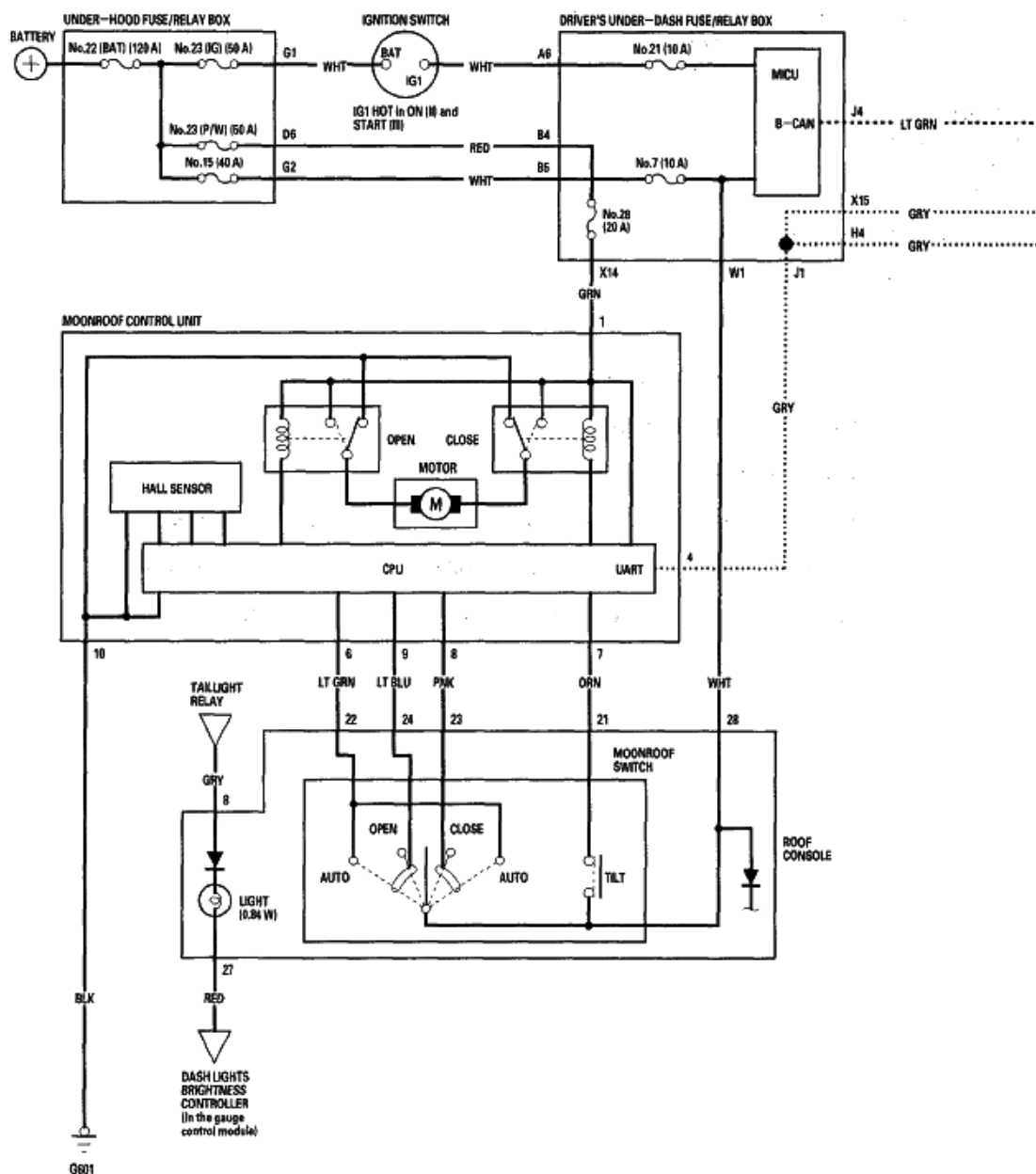

**Fig. 2: Moonroof Component - Circuit Diagram (1 Of 2)**  
 Courtesy of AMERICAN HONDA MOTOR CO., INC.

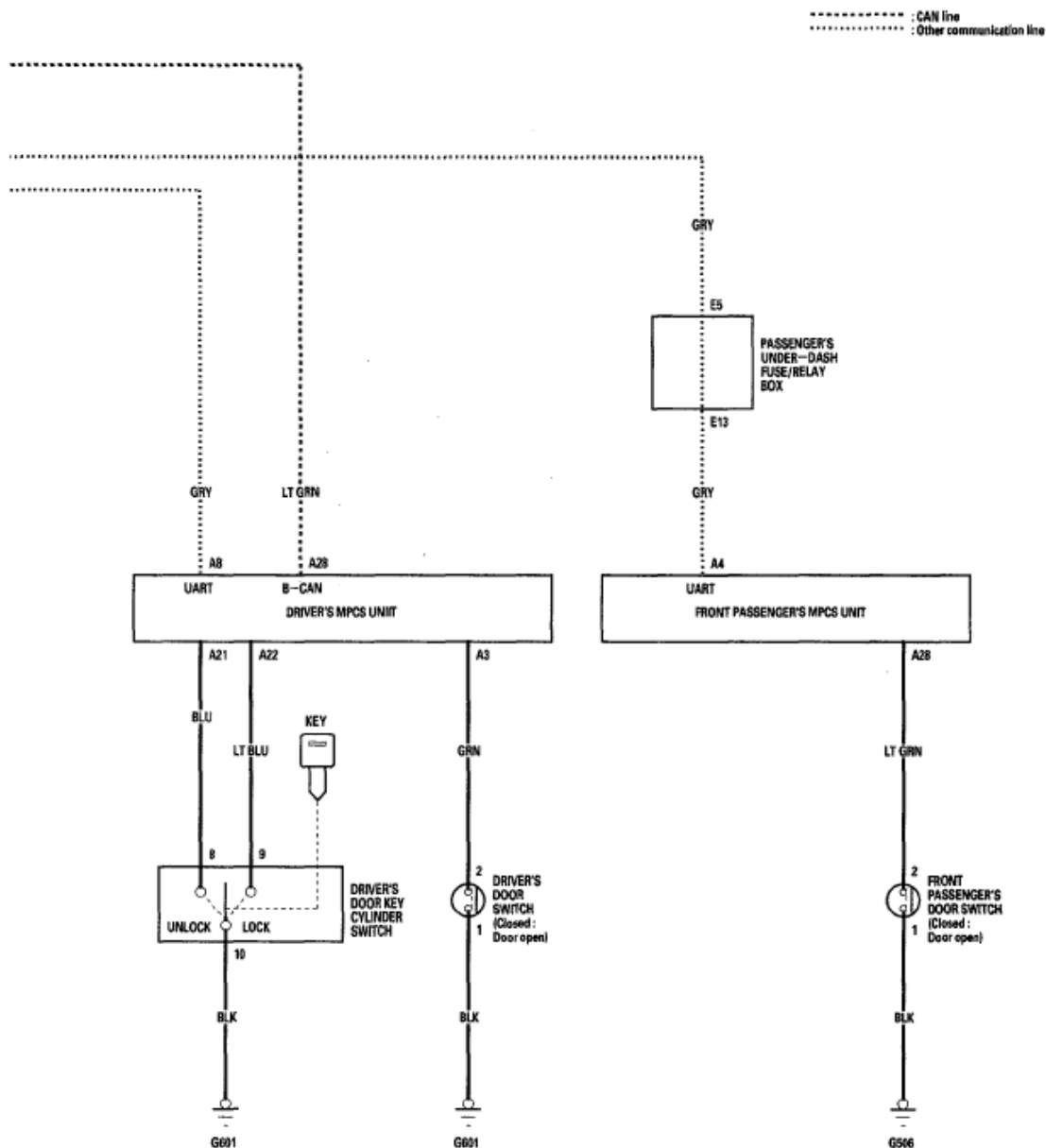

**Fig. 3: Moonroof Component - Circuit Diagram (2 Of 2)**  
 Courtesy of AMERICAN HONDA MOTOR CO., INC.

## MOONROOF CONTROL UNIT INPUT TEST

Before troubleshooting the moonroof circuit, troubleshoot the multiplex integrated control system using B-CAN System Diagnosis Test Mode A (see **TROUBLESHOOTING - B-CAN SYSTEM DIAGNOSIS TEST MODE A** ).

If the moonroof works OK manually, but will not work in AUTO, or reverses frequently (pinch detection), do the moonroof calibration (see **RESETTING THE MOONROOF CONTROL UNIT** ) before proceeding with the input test.

1. Turn the ignition switch OFF.
2. Remove the headliner (see **HEADLINER REMOVAL/INSTALLATION** ).

3. Disconnect the 10P connector (A) from the moonroof control unit (B).

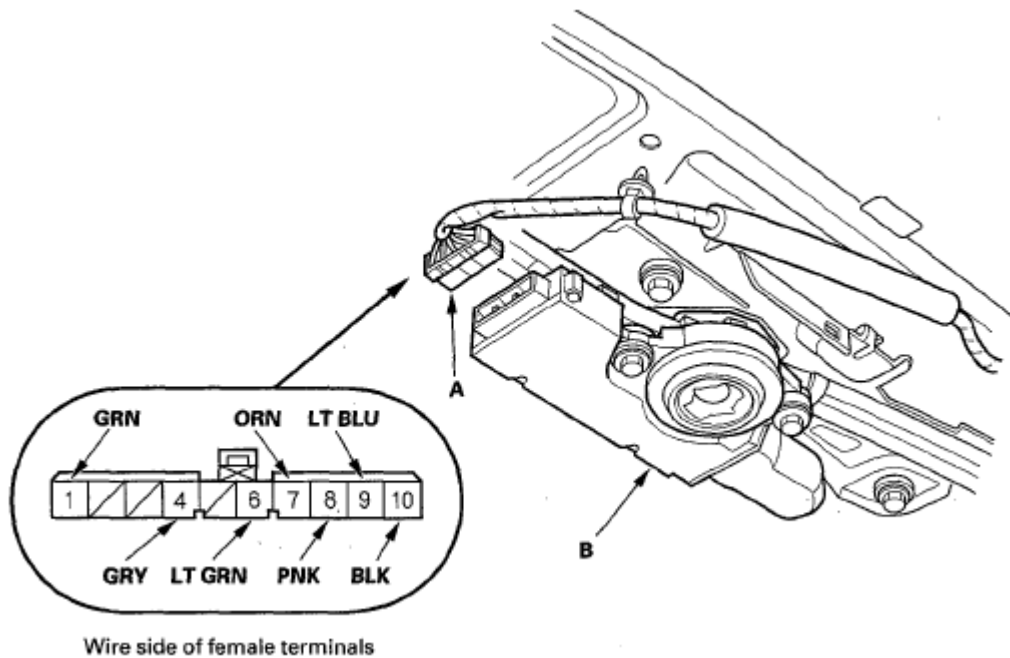

**Fig. 4: Identifying Moonroof Control Unit And 10P Connector**  
 Courtesy of AMERICAN HONDA MOTOR CO., INC.

4. Inspect the connector and socket terminals to be sure they are all making good contact.
- If the terminals are bent, loose or corroded, repair them as necessary, and recheck the system.
  - If the terminals look OK, go to step 5.
5. Reconnect the connector to the control unit, and make these input tests at the connector.
- If any test indicates a problem, find and correct the cause, then recheck the system.
  - If all the input tests prove OK, go to step 6.

#### WIRE CAVITY REFERENCE CHART

Cavity	Wire	Test condition	Test: Desired result	Possible cause if desired result is not obtained
10	BLK	Under all conditions	Measure the voltage to ground: There should be less than 0.5 V.	<ul style="list-style-type: none"> <li>• Poor ground (G601)</li> <li>• An open in the wire</li> </ul>
1	GRIM	Under all conditions	Measure the voltage to ground: There should be battery voltage.	<ul style="list-style-type: none"> <li>• Blown No. 28 (20 A) fuse in the driver's under-dash fuse/relay box</li> <li>• An open in the wire</li> </ul>
		Moonroof switch in OPEN	Measure the voltage to	<ul style="list-style-type: none"> <li>• Blown No. 15 (40 A) fuse in the under-hood fuse/relay box</li> <li>• Blown No. 7 (10 A) fuse in</li> </ul>

## 2007 Acura RL

### 2005-08 ACCESSORIES AND EQUIPMENT Moonroof (Body Electrical) - RL

6	LT GRN	(AUTO) or CLOSE (AUTO) position	ground: There should be battery voltage.	the driver's under-dash fuse/relay box <ul style="list-style-type: none"> <li>Faulty moonroof switch</li> <li>Faulty roof console</li> <li>An open in the wire</li> </ul>
7	ORN	Moonroof switch in TILT position	Measure the voltage to ground: There should be battery voltage.	<ul style="list-style-type: none"> <li>Blown No. 15 (40 A) fuse in the under-hood fuse/relay box</li> <li>Blown No. 7 (10 A) fuse in the driver's under-dash fuse/relay box</li> <li>Faulty moonroof switch</li> <li>Faulty roof console</li> <li>An open in the wire</li> </ul>
8	PNK	Moonroof switch in CLOSE position	Measure the voltage to ground: There should be battery voltage.	<ul style="list-style-type: none"> <li>Blown No. 15(40 A) fuse in the under-hood fuse/relay box</li> <li>Blown No. 7 (10 A) fuse in the driver's under-dash fuse/relay box</li> <li>Faulty moonroof switch</li> <li>Faulty roof console</li> <li>An open in the wire</li> </ul>
9	LT BLU	Moonroof switch in OPEN position	Measure the voltage to ground: There should be battery voltage.	<ul style="list-style-type: none"> <li>Blown No. 15 (40 A) fuse in the under-hood fuse/relay box</li> <li>Blown No. 7 (10 A) fuse in the driver's under-dash fuse/relay box</li> <li>Faulty moonroof switch</li> <li>Faulty roof console</li> <li>An open in the wire</li> </ul>

6. Disconnect the 10P connector from the control unit, and make these input tests at the connector.

- If any test indicates a problem, find and correct the cause, then recheck the system.
- If all the input tests prove OK, go to step 7.

#### WIRE CAVITY REFERENCE CHART

Cavity	Wire	Test condition	Test: Desired result	Possible cause if desired result is not obtained
		Under all conditions	Check for continuity between the No. 4 terminal and driver's MPCS unit connector A (40P) No. 8 terminal:	An open in the wire

## 2007 Acura RL

### 2005-08 ACCESSORIES AND EQUIPMENT Moonroof (Body Electrical) - RL

4	GRY		There should be continuity.	An open in the wire
		Under all conditions	Check for continuity between the No. 4 terminal and front passenger's MPCS unit connector A (28P) No. 4 terminal: There should be continuity.	

7. If all the input tests are OK and multiple failures are found, replace the moonroof motor assembly. If the problem is related to the key-off operation, go to the driver's MPCS unit input test (see **CONTROL UNIT INPUT TEST** ), and front passenger's MPCS unit input test (see **CONTROL UNIT INPUT TEST** ).

## MOONROOF SWITCH TEST/REPLACEMENT

1. Remove the roof console (see **ROOF CONSOLE REPLACEMENT** ).
2. Remove the HomeLink unit from the top of the roof console.
3. Remove the five screws from the roof console (A) and remove the rear cover (B).

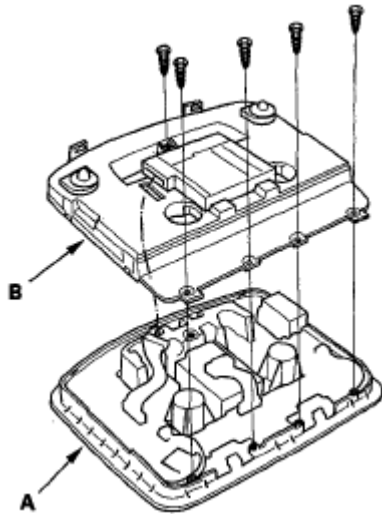

**Fig. 5: Identifying Rear Cover And Roof Console**  
Courtesy of AMERICAN HONDA MOTOR CO., INC.

4. Disconnect the 7P connector (A) from the moonroof switch (B), then remove the two screws and switch.

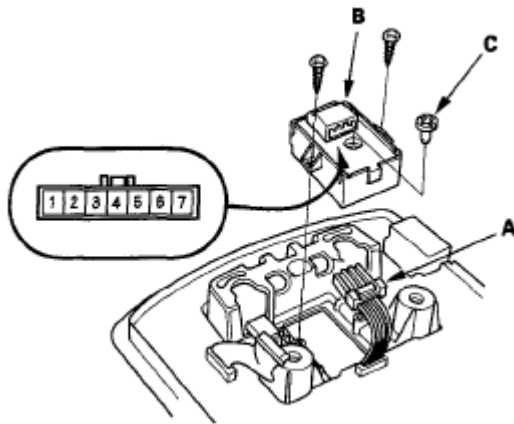

**Fig. 6: Identifying Moonroof Switch And 7P Connector**  
Courtesy of AMERICAN HONDA MOTOR CO., INC.

5. Check for continuity between the terminals in each switch position (see **Fig. 7**).

Terminal Position	1	2	3	6	7	4		5
OPEN	○	○	○			○	○	○
CLOSE	○				○		○	○
TILT	○	○				○	○	○
CLOSE+AUTO	○			○	○	○	○	○
OPEN+AUTO	○		○	○		○	○	○

**Fig. 7: Checking For Continuity Between Terminals In Each Switch Position**  
Courtesy of AMERICAN HONDA MOTOR CO., INC.

6. If the continuity is not as specified, replace the illumination bulb (C) or the switch.
7. If the switch is OK, but there is a malfunction related to the moonroof switch operation, replace the roof console (see **ROOF CONSOLE REPLACEMENT** ).
8. Install in the reverse order of removal.